

# DTC Series EMC Filters

Compliance Engineering's DTC series of EMC filters are compact high current rating tubular filters with excellent insertion loss, climate tolerance and reliability. They are suited to installations where bulkhead mounting is required.



Technical Data	
Rated Voltage:	250VAC
Operating Frequency:	50 / 60 Hz
Current Rating:	16A – 200A
Test Voltage (1 min):	2250 VDC (line to ground)
Climate Category	40 / 085 / 56

Model	Rated Current (A)	Rated Capacitance (nF)	Leakage Current $\leq$ (mA)	Circuit Diagram	Dimension Figure
16DTC	16	2 x 22	4.14	1	1
63DTC	63	2 x 470	88.5	1	2
100DTC	100	2 x 1000	188	1	3
200DTC	200	2 x 1000	188	1	4

## Typical Circuit Diagram

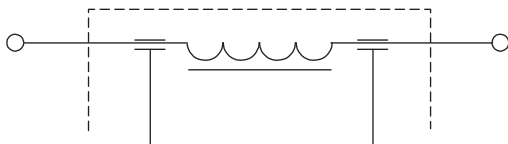

**Outline Drawings and Dimension (mm)**

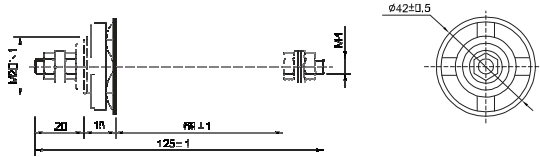

**Figure 1.**

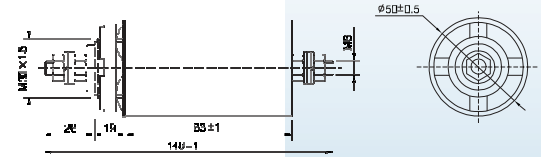

**Figure 2.**

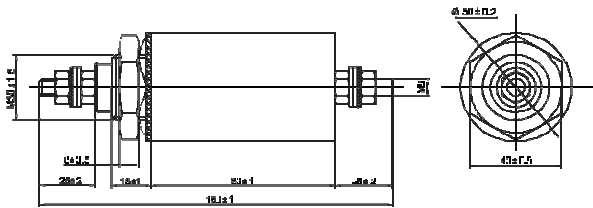

**Figure 3.**

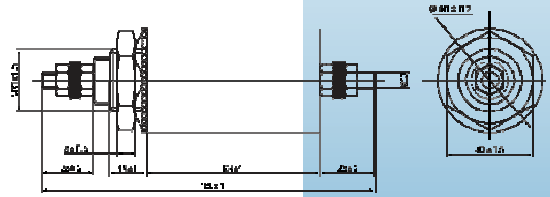

**Figure 4.**

**Insertion Loss in dB (Measured in 50 Ω system as per IEC/CISPR NO.17)**

**Common Mode** ————— **Differential Mode** - - - - -

